

BRIDGE (D1C2)
Rating 2000, Cost 6000

Captain's Chair _____
(+10 Airship Tactics)

Helm _____
(+2 Piloting)

Malfunctions: _____

Malfunction:
[1-29: Nothing][30-49: Instrument Damage]
[50-69: Throttle Jammed][70-89: Rudder Jammed][90-100: Control cables severed]
Destroyed:
[Out of Control]

BOILER (D3C3)
Rating 3000, Cost 24000
Generates: 9000 Steam

Fuel: _____ / **9**

Stoker's Controls _____
(No bonus)

Malfunctions: _____

Malfunction:
[10-39: Nothing][40-59: Fire!][60-69: Explosion]
[70-79: FIRE!!!][80-89: EXPLOSION!!!][90-100: Fuel Fire!]
Destroyed:
[1-19: Nothing][20-49: Fire!][50-69: Explosion!]
[70-89: FIRE!!!][90-100: EXPLOSION!!!]

PRESSURE TANK (D3C2)
Rating 2000, Cost 16000
Maximum pressure: 20,000

Boiler Controls _____
(No bonus)

Overcharge:
[1-49: Malfunction][50-59: No Effect]
[60-69: +1000 Steam][70-79: +2000 Steam]
[80-89: +3000 Steam][90-100: +4000 Steam]

Malfunctions: _____

Malfunction:
[1-39: Nothing][40-69: Steam Leak]
[70-100: STEAM LEAK!!!]
Destroyed:
[1-70: Nothing][71-100: Boiler Rupture]

ENGINES

ENGINE 1 (D3C1)
Rating 3000, Cost 27000
Maximum lift: 3000

Control Panel _____
(+6 Repair)

Overcharge:
[1-29: Malfunction][30-49: Nothing][50-59: +150 Power]
[60-69: +300 Power][70-79: +460 Power]
[80-89: +600 Power][90-100: +750 Power]

Malfunctions: _____

Malfunction:
[10-29 Nothing][30-49 Steamline Rupture]
[50-59 Fire!][60-69 Explosion!][70-79 FIRE!!!][80-89 Disabled][90-100 EXPLOSION!!!]
Destroyed:
[1-19: Nothing][20-39 Fire!][40-59: Explosion!][FIRE!! 60-79][80-100: EXPLOSION!!!]

ENGINE 2 (D3C4)
Rating 3000, Cost 27000
Maximum lift: 3000

Control Panel _____
(+6 Repair)

Overcharge:
[1-29: Malfunction][30-49: Nothing][50-59: +150 Power]
[60-69: +300 Power][70-79: +460 Power]
[80-89: +600 Power] [90-100: +750 Power]

Malfunctions: _____

Malfunction:
[10-29 Nothing][30-49 Steamline Rupture]
[50-59 Fire!][60-69 Explosion!][70-79 FIRE!!!][80-89 Disabled][90-100 EXPLOSION!!!]
Destroyed:
[1-19: Nothing][20-39 Fire!][40-59: Explosion!][FIRE!! 60-79][80-100: EXPLOSION!!!]

ARMAMENT

Aft Turret (D1C1)
Rating 2000 Cost 25200
Damage: 16
Steam Charge: 1800

Gunner's Seat _____
(No bonus)

Overcharge:
[1-29: Malfunction][30-49 Nothing]
[50-59: +1 Damage][60-79: +2 Damage]
[80-89: +3Damage][90-100: +4 Damage]

Ammo: _____ / **22**

Malfunctions: _____

Malfunction:
[1-29: Nothing][30-59: Control Damage]
[60-69: Jammed][70-79: Fire!] [80-90: FIRE!!!]
[90-100: Destroyed]

Destroyed:
[1-39: Nothing][40-59: Fire!][60-79: FIRE!!]
[80-100: Ammo Explosion!]

Forward Turret (D2C4)
Rating 2000 Cost 252 00
Damage: 16
Steam Charge: 1800

Gunner's Seat _____
(No bonus)

Overcharge:
[1-29: Malfunction][30-49 Nothing]
[50-59: +1 Damage][60-79: +2 Damage]
[80-89: +3Damage][90-100: +4 Damage]

Ammo: _____ / **22**

Malfunctions: _____

Malfunction:
[1-29: Nothing][30-59: Control Damage]
[60-69: Jammed][70-79: Fire!] [80-90: FIRE!!!]
[90-100: Destroyed]

Destroyed:
[1-39: Nothing][40-59: Fire!][60-79: FIRE!!]
[80-100: Ammo Explosion!]

GRAPPLE

GRAPPLE (D2C1)
Rating 2000, Cost 8,000
Power: 200
Steam Charge: 2000

Control Station _____
(+8 Mechanical)

Overcharge:
[1-29: Malfunction][30-49: Nothing]
[50-59: +10 Power][60-69: +20 Power]
[70-79: +30 Power][80-89: +40 Power]
[90-100: +50 Power]

Malfunctions: _____

Malfunction:
[1-39: Nothing][40-49: Vacuum Leak][50-59: Fire]
[60-69: Explosion][70-79: FIRE!]
[80-89: EXPLOSION!!!] [90-100: Disabled]

Destroyed:
[1-19: Nothing][20-49: Fire!][50-69: Explosion]
[70-89: FIRE!][90-100: EXPLOSION!!!]

FLIGHT

Flight: 1300

Forward 720

Reverse: 1040

Turn: 45° 360

Turn: 90° 720

Turn: 135° 1080

Turn: 180° 1440

Lateral: 1170

Ascend: 1950

Descend: 300

Dive: 390

PILOTING

Forward 6

Reverse 12

Turn: 45° 5

Turn: 90° 12

Turn: 135° 25

Turn: 180° 60

Lateral: 14

Ascent/Descent 7

Dive 11

OVERSPEED: 9

EVASION: 2.3

CARGO

Cargo 1 (D4C1)
Rating 2000, Cost 2000

| Item. | Size | Amt. | Wgt. | Total Wgt |
|----------------|------|------|------|-----------|
| 01. | /100 | | | |
| 02. | /100 | | | |
| 03. | /100 | | | |
| 04. | /100 | | | |
| 05. | /100 | | | |
| 06. | /100 | | | |
| Overall Weight | | | | |

Malfunction:
[1-59: Nothing][60-79: 1 Slot destroyed][80-100: 2 Slots destroyed]

Destroyed:
[D100 / 20 slots destroyed, compartment Unuseable till repaired]

CARGO

Cargo 2 (D4C2)
Rating 2000, Cost 2000

| Item. | Size | Amt. | Wgt. | Total Wgt |
|----------------|------|------|------|-----------|
| 01. | /100 | | | |
| 02. | /100 | | | |
| 03. | /100 | | | |
| 04. | /100 | | | |
| 05. | /100 | | | |
| 06. | /100 | | | |
| Overall Weight | | | | |

Malfunction:
[1-59: Nothing][60-79: 1 Slot destroyed][80-100: 2 Slots destroyed]

Destroyed:
[D100 / 20 slots destroyed, compartment Unuseable till repaired]

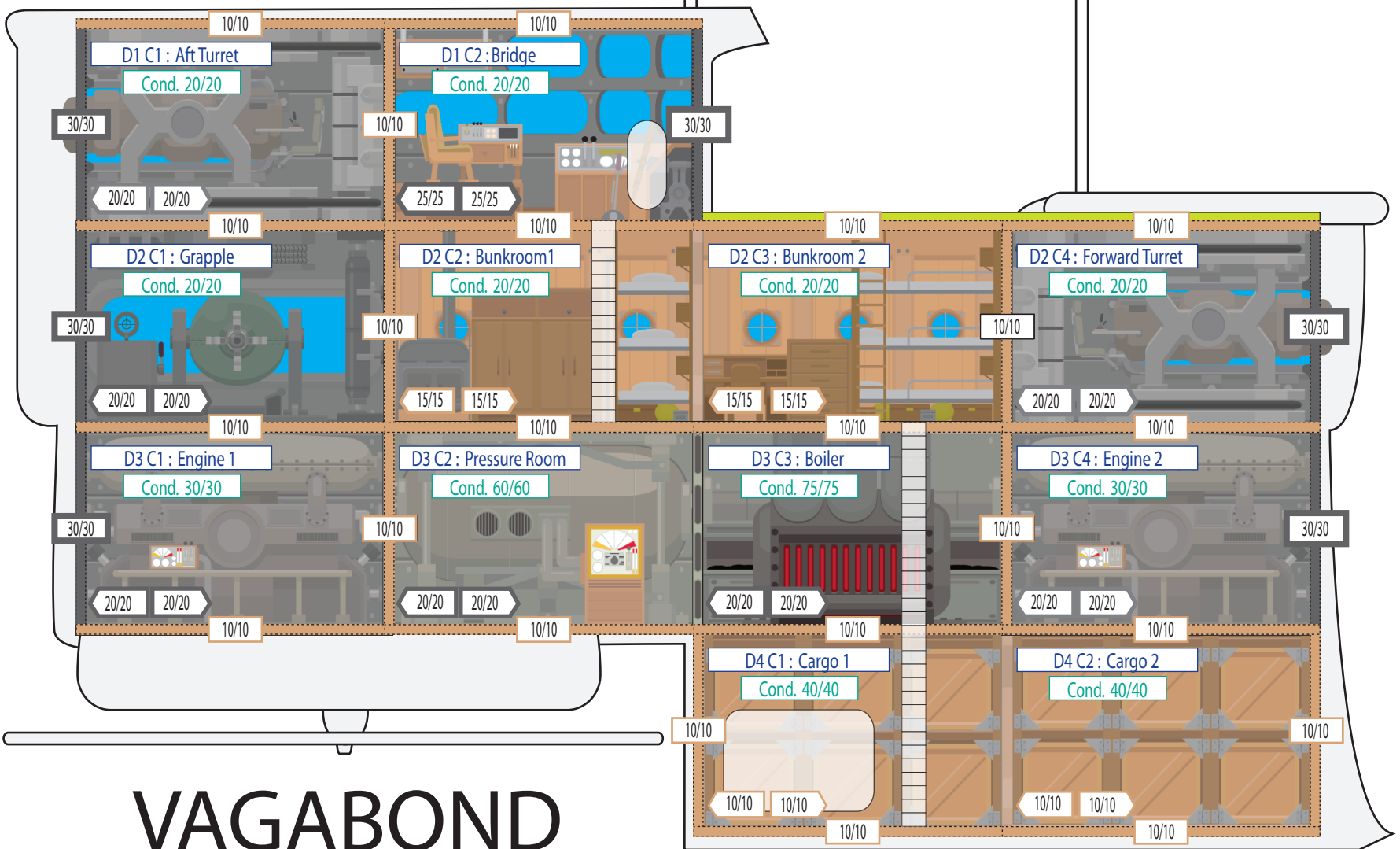

VAGABOND (Raider variant)

[Bulk: 120] [Empty Weight: 130.2 Tons] [Max Power : 6000 Hp] [Firepower: 32]
[Armor: 840] [Crew: 12] [Cargo: 12] [Level Speed: 65.2 K/h][Overspeed: 90 K/h]
[Evasion: 2.3][Max Climb: 2,400 f/m] [Max Range: 14,083 Km] [Value: \$251,150]
[Total Rating: 27,000][Avg. Rating: 2,250] [1.2]

BUNKS

Bunk 1 (D2C2)
Rating 2000, Cost 2000
(Comfort 12)

| | |
|-----|--|
| 01. | |
| 02. | |
| 03. | |
| 04. | |
| 05. | |
| 06. | |

Malfunction:
1-19: 1 Bunk destroyed][20-39: 2 Bunks destroyed]
[40-59: 3 Bunks destroyed][60-79: 4 Bunks destroyed]
[80-100: 5 Bunks destroyed]

Destroyed:
[The entire bunk room is unusable until repaired.]

BUNKS

Bunk 2 (D2C3)
Rating 2000, Cost 2000
(Comfort 12)

| | |
|-----|--|
| 01. | |
| 02. | |
| 03. | |
| 04. | |
| 05. | |
| 06. | |

Malfunction:
1-19: 1 Bunk destroyed][20-39: 2 Bunks destroyed]
[40-59: 3 Bunks destroyed][60-79: 4 Bunks destroyed]
[80-100: 5 Bunks destroyed]

Destroyed:
[The entire bunk room is unusable until repaired.]

HIT TABLE

| | Front/Rear | Top/Bottom |
|---------|------------|------------|
| 1-25: | Deck 1 | C1 |
| 26-50: | Deck 2 | C2 |
| 51-75: | Deck 3 | C3 |
| 76-100: | Deck 4 | C4 |

| Side | D1 | D2 | D3 | D4 |
|--------------|------------|------------|------------|------------|
| START | | | | |
| 1-17: D1 | 1-50: C1 | 1-25: C1 | 1-25: C1 | 1-50: C1 |
| 18-50: D2 | 51-100: C2 | 26-50: C2 | 26-50: C2 | 51-100: C2 |
| 51-83: D3 | | 51-75: C3 | 51-75: C3 | |
| 84-100: D4 | | 76-100: C4 | 76-100: C4 | |