

BRIDGE (D1C2)
Rating 2000, Cost 6000

Captain's Chair _____
(+10 Airship Tactics)

Helm _____
(+2 Piloting)

Malfunctions: _____

Malfunction:
[1-29: Nothing][30-49: Instrument Damage]
[50-69: Throttle Jammed][70-89: Rudder Jammed][90-100: Control cables severed]
Destroyed:
[Out of Control]

BOILER (D3C3)
Rating 3000, Cost 24000
Generates: 9000 Steam

Fuel: _____ / **9**

Stoker's Controls _____
(No bonus)

Malfunctions: _____

Malfunction:
[10-39: Nothing][40-59: Fire!][60-69: Explosion]
[70-79: FIRE!!!][80-89: EXPLOSION!!!][90-100: Fuel Fire!]
Destroyed:
[1-19: Nothing][20-49: Fire!][50-69: Explosion!]
[70-89: FIRE!!!][90-100: EXPLOSION!!!]

PRESSURE TANK (D3C2)
Rating 2000, Cost 16000
Maximum pressure: 20,000

Boiler Controls _____
(No bonus)

Overcharge:
[1-49: Malfunction][50-59: No Effect]
[60-69: +1000 Steam][70-79: +2000 Steam]
[80-89: +3000 Steam][90-100: +4000 Steam]

Malfunctions: _____

Malfunction:
[1-39: Nothing][40-69: Steam Leak]
[70-100: STEAM LEAK!!!]
Destroyed:
[1-70: Nothing][71-100: Boiler Rupture]

ENGINES

ENGINE 1 (D3C1)
Rating 3000, Cost 27000
Maximum lift: 3000

Control Panel _____
(+6 Repair)

Overcharge:
[1-29: Malfunction][30-49: Nothing][50-59: +150 Power]
[60-69: +300 Power][70-79: +460 Power]
[80-89: +600 Power][90-100: +750 Power]

Malfunctions: _____

Malfunction:
[10-29 Nothing][30-49 Steamline Rupture]
[50-59 Fire!][60-69 Explosion!][70-79 FIRE!!!][80-89 Disabled][90-100 EXPLOSION!!!]
Destroyed:
[1-19: Nothing][20-39 Fire!][40-59: Explosion!][FIRE!! 60-79][80-100: EXPLOSION!!!]

ENGINE 2 (D3C4)
Rating 3000, Cost 27000
Maximum lift: 3000

Control Panel _____
(+6 Repair)

Overcharge:
[1-29: Malfunction][30-49: Nothing][50-59: +150 Power]
[60-69: +300 Power][70-79: +460 Power]
[80-89: +600 Power][90-100: +750 Power]

Malfunctions: _____

Malfunction:
[10-29 Nothing][30-49 Steamline Rupture]
[50-59 Fire!][60-69 Explosion!][70-79 FIRE!!!][80-89 Disabled][90-100 EXPLOSION!!!]
Destroyed:
[1-19: Nothing][20-39 Fire!][40-59: Explosion!][FIRE!! 60-79][80-100: EXPLOSION!!!]

ARMAMENT

Aft Turret (D1C1)
Rating 2000 Cost 25200
Damage: 16
Steam Charge: 1800

Gunner's Seat _____
(No bonus)

Overcharge:
[1-29: Malfunction][30-49 Nothing]
[50-59: +1 Damage][60-79: +2 Damage]
[80-89: +3Damage][90-100: +4 Damage]

Ammo: _____ / **22**

Malfunctions: _____

Malfunction:
[1-29: Nothing][30-59: Control Damage]
[60-69: Jammed][70-79: Fire!][80-90: FIRE!!]
[90-100: Destroyed]

Destroyed:
[1-39: Nothing][40-59: Fire!][60-79: FIRE!!]
[80-100: Ammo Explosion!]

Forward Turret (D2C4)
Rating 2000 Cost 252 00
Damage: 16
Steam Charge: 1800

Gunner's Seat _____
(No bonus)

Overcharge:
[1-29: Malfunction][30-49 Nothing]
[50-59: +1 Damage][60-79: +2 Damage]
[80-89: +3Damage][90-100: +4 Damage]

Ammo: _____ / **22**

Malfunctions: _____

Malfunction:
[1-29: Nothing][30-59: Control Damage]
[60-69: Jammed][70-79: Fire!][80-90: FIRE!!]
[90-100: Destroyed]

Destroyed:
[1-39: Nothing][40-59: Fire!][60-79: FIRE!!]
[80-100: Ammo Explosion!]

ARMAMENT

Sidegun (D2C1)
Rating 2000 Cost 18000
Damage: 20
Steam Charge: 1400

Gunner's Seat _____
(No bonus)

Overcharge:
[1-29: Malfunction][30-49 Nothing]
[50-59: +1 Damage][60-69: +2 Damage]
[70-79: + 3% Damage][80-89: +4%Damage]
[90-100: +5 Damage]

Ammo: _____ / **6**

Malfunctions: _____

Malfunction:
[1-29: Nothing][30-59: Control Damage]
[60-69: Jammed][70-79: Fire!][80-90: FIRE!!]
[90-100: Destroyed]

Destroyed:
[1-39: Nothing][40-59: Fire!][60-79: FIRE!!]
[80-100: Ammo Explosion!]

FLIGHT

Flight: 1320

Forward 730

Reverse: 1060

Turn: 45° 360

Turn: 90° 720

Turn: 135° 1080

Turn: 180° 1440

Lateral: 1190

Ascend: 1980

Descend: 300

Dive: 400

PILOTING

Forward 6

Reverse 12

Turn: 45° 5

Turn: 90° 12

Turn: 135° 25

Turn: 180° 60

Lateral: 14

Ascent/Descent 7

Dive 11

OVERSPEED: 9

EVASION: 2.3

CARGO

Cargo 1 (D4C1)
Rating 2000, Cost 2000

Item.	Size	Amt.	Wgt.	Total Wgt
01.	/100			
02.	/100			
03.	/100			
04.	/100			
05.	/100			
06.	/100			
Overall Weight				

Malfunction:
[1-59: Nothing][60-79: 1 Slot destroyed][80-100: 2 Slots destroyed]

Destroyed:
[D100 / 20 slots destroyed, compartment Unuseable till repaired]

CARGO

Cargo 2 (D4C2)
Rating 2000, Cost 2000

Item.	Size	Amt.	Wgt.	Total Wgt
01.	/100			
02.	/100			
03.	/100			
04.	/100			
05.	/100			
06.	/100			
Overall Weight				

Malfunction:
[1-59: Nothing][60-79: 1 Slot destroyed][80-100: 2 Slots destroyed]

Destroyed:
[D100 / 20 slots destroyed, compartment Unuseable till repaired]

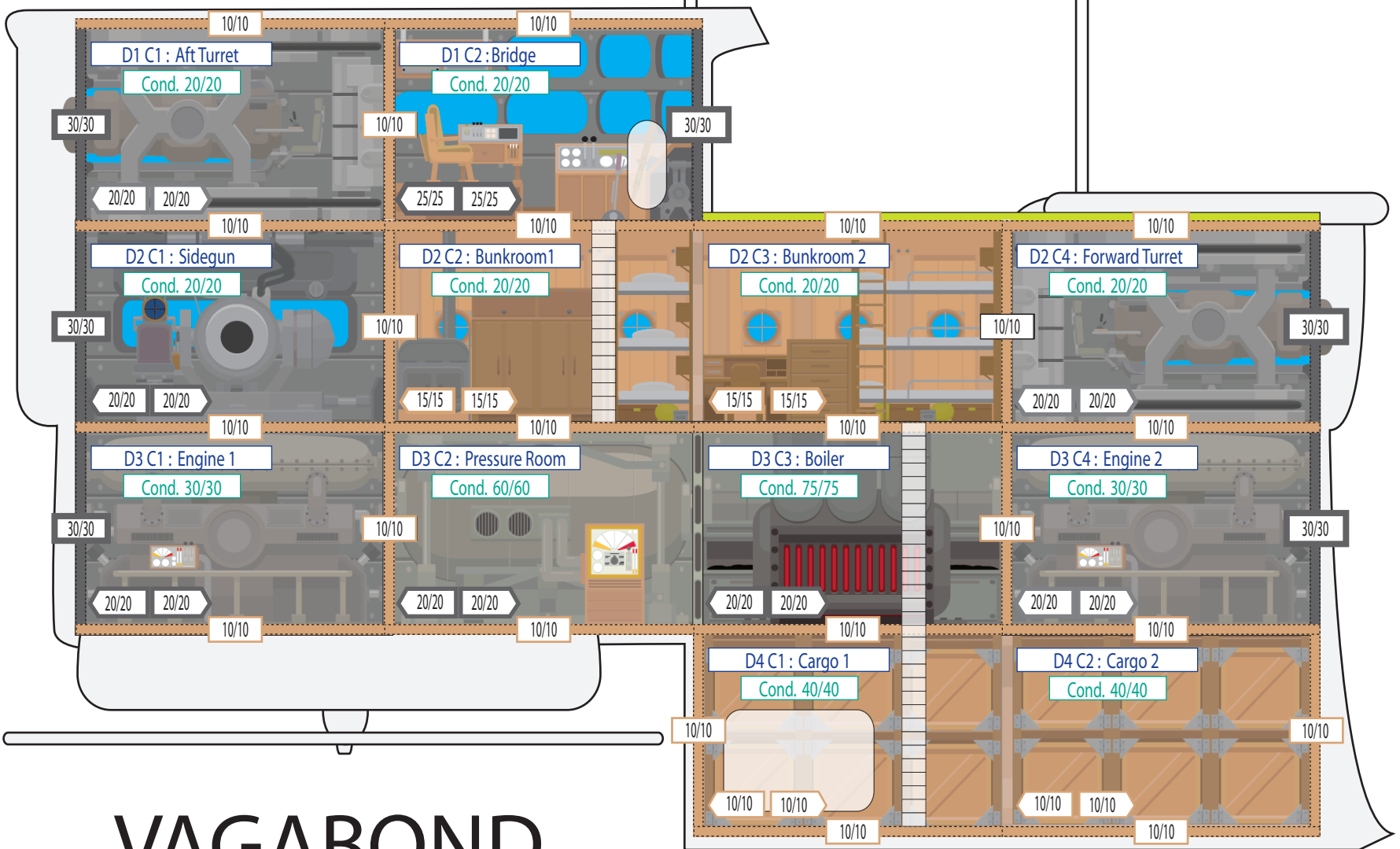

VAGABOND

Caterina Shipyards

[Bulk: 120] [Empty Weight: 132.2 Tons] [Max Power : 6000 Hp] [Firepower: 52]
[Armor: 840] [Crew: 12] [Cargo: 12] [Level Speed: 64.1 K/h][Overspeed: 90 K/h][Evasion: 2.3][Max Climb: 2,300 f/m] [Max Range: 13,845 Km] [Value: \$261,150]
[Total Rating: 27,000][Avg. Rating: 2,250] [1.2]

BUNKS

Bunk 1 (D2C2)
Rating 2000, Cost 2000
(Comfort 12)

01.	
02.	
03.	
04.	
05.	
06.	

Malfunction:
1-19: 1 Bunk destroyed][20-39: 2 Bunks destroyed]
[40-59: 3 Bunks destroyed][60-79: 4 Bunks destroyed]
[80-100: 5 Bunks destroyed]

Destroyed:
[The entire bunk room is unusable until repaired.]

BUNKS

Bunk 2 (D2C3)
Rating 2000, Cost 2000
(Comfort 12)

01.	
02.	
03.	
04.	
05.	
06.	

Malfunction:
1-19: 1 Bunk destroyed][20-39: 2 Bunks destroyed]
[40-59: 3 Bunks destroyed][60-79: 4 Bunks destroyed]
[80-100: 5 Bunks destroyed]

Destroyed:
[The entire bunk room is unusable until repaired.]

HIT TABLE

	Front/Rear	Top/Bottom
1-25:	Deck 1	C1
26-50:	Deck 2	C2
51-75:	Deck 3	C3
76-100:	Deck 4	C4

Side START	D1	D2	D3	D4
1-17:	D1	1-50: C1	1-25: C1	1-50: C1
18-50:	D2	51-100: C2	26-50: C2	51-100: C2
51-83:	D3		51-75: C3	
84-100:	D4		76-100: C4	